

South Beach Road, Hunstanton, Norfolk PE36 5BB

Holiday Home Sales 01485 536026 Fax 01485 536015

Email: lodges@searles.co.uk www.searles.co.uk

New Pathfinder Retreat 2023

48' x 20' 3 Bed

Location RG131

£267,750

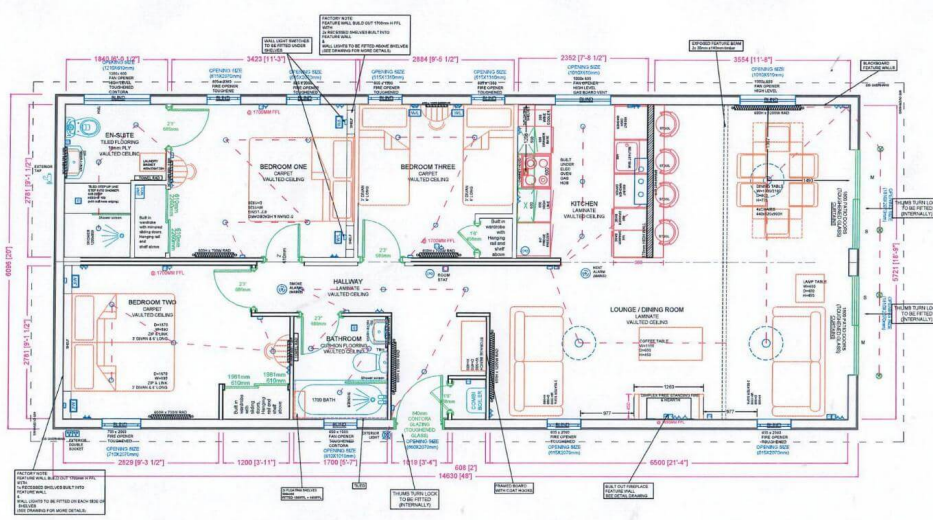

- For Sale by Searles Leisure Group and includes a **comprehensive warranty**.
- **Rustic farmhouse aesthetic** throughout with large light and airy windows.
- Larger grey front deck with **glass balustrade** upgrade included.

This beautiful lodge has 3 bedrooms and is located in Redgate Court where there is spacious parking for 3 vehicles.

Upon entry you walk into an cloak area to hang your the outdoor belongings before entering into the spacious open plan kitchen/diner/living room.

The rustic farmhouse aesthetic throughout forms a unique homely experience, with plenty light pouring in, that creates a warming atmosphere. The kitchen includes an island where four stalls are located opening onto the dining area. With a oven, hob and extractor fan, and also a dishwasher.

The lounge has 2 double sofas. The living area has 2 sliding doors that stretch out onto the large decking which welcomes sun throughout the day.

The holiday home has two spacious double bed bedrooms with the master flowing onto a en suite which encompasses a large shower, toilet and basin. Both double bedroom have integrated mirrored wardrobes with ample storage space and a dressing table and stall. The 3rd bedroom is a large twin with a side table and wardrobe space.

Includes an upgrade to a larger than normal grey UPVC decking with glass balustrades.

